

PLAN NOTES:

- 1

INFILL FORMER OPENING WITH CMU.
- 2

NEW CMU WALL.
- 3

2x4 WOOD STUDS W/ R19 BATT INSULATION AND 5/8 GYP. BRD. PAINTED.
- 4

5'x5' CONC. LANDING
- 5

NEW STUCCO CEILING (OPT.: HARDIE PANEL).

6

NEW 2x2 ACOUST. TILE CEILING, GRID & INSULATION.

7

NEW VCT TILE FLOORING.

8

CLEAN, PATCH AND PAINT EXIST. & NEW WALLS.

9

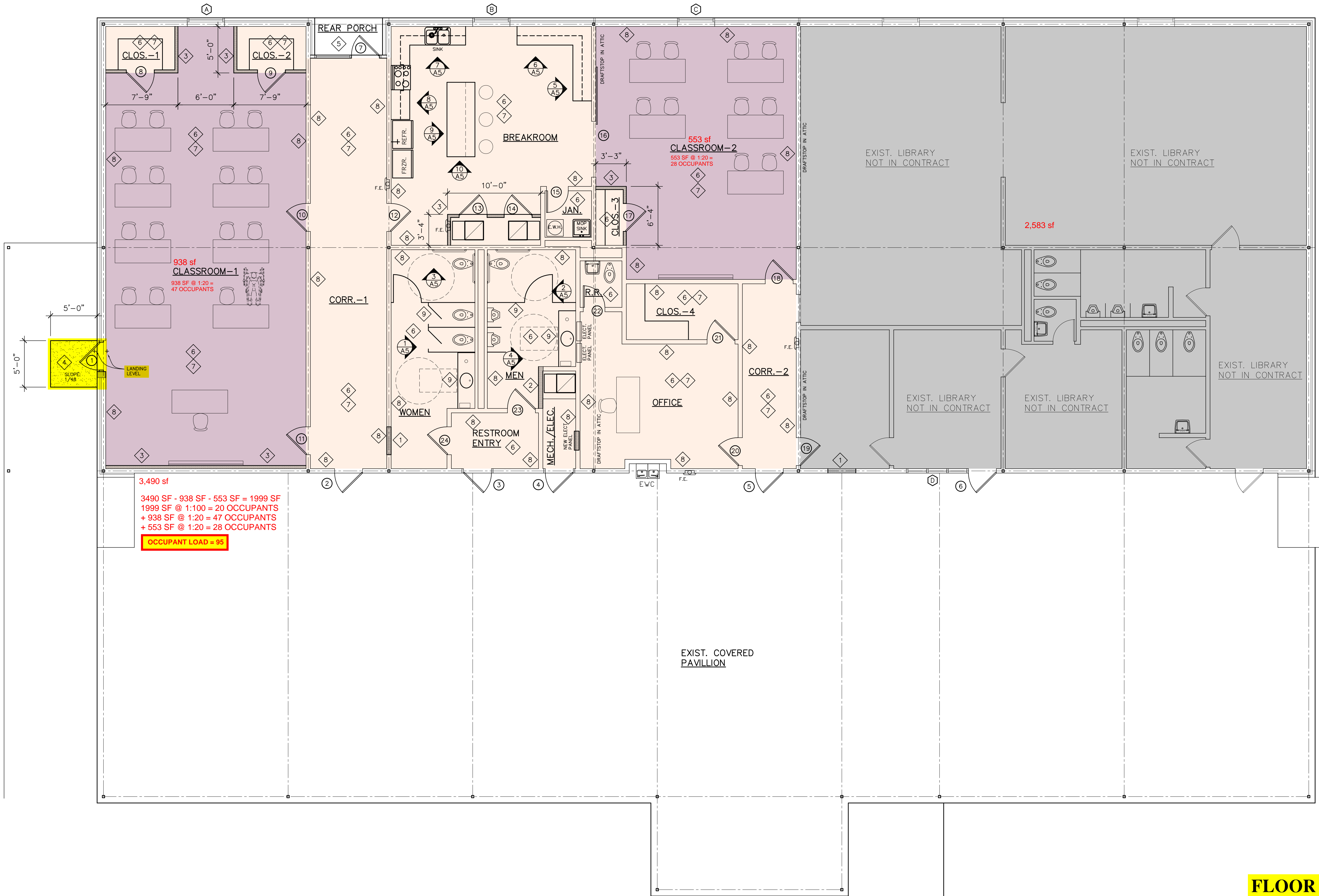
NEW TOILET PARTITIONS & PLUMB. FIXTURES.

FLOOR PLAN

SCALE: 3/16"=1'-0"

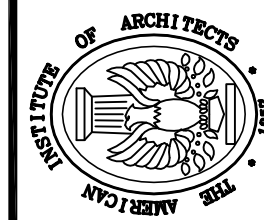

318-765-2747

KENNETH C. BERGERON
AIA - Architect
196 C. Rachal Rd. - Pollock, La. 71467

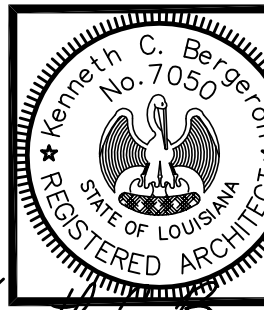

DATE:	1/30/26
REVISED:	
JOB NO.	
DRAWN BY:	K.C.B.
CHECKED BY:	K.C.B.

REVIEWED FOR
STATE FIRE MARSHAL
AS PER REVIEW LETTER
BY: JEFF GONSOLIN

AF-26-001927
REVIEWED 02-09-2026

NEW TRAINING CENTER FOR:
Bordelonville Fire Department
BORDELONVILLE, LA.

SHEET NUMBER
A3
3 of 9